



Board to Board  
Connectors

Emboss  
Type

SMT  
Type

2B4001 Series  
Wafer Vertical

Specifications:

2B

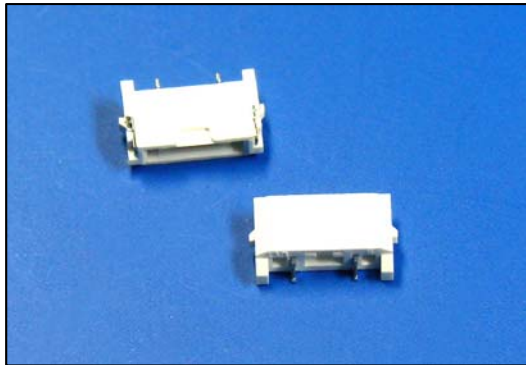

- Rated Voltage: 300V AC,DC
- Rated Current: 3.0A AC,DC
- Withstand Voltage: 1,700V AC/Minute
- Contact Resistance: 20m Ω (Max.)
- Insulation Resistance: 1000M Ω (Min.)
- Temperature Range: -55°C~+105°C

Material:

- Base: High Temperature Plastic Natural UL 94V-0
- PIN: Phosphor Bronze, Tin-plated
- Solder tab: Phosphor Bronze, Tin-plated

Mates With:

- Mates With: 2B4001WOM0-02

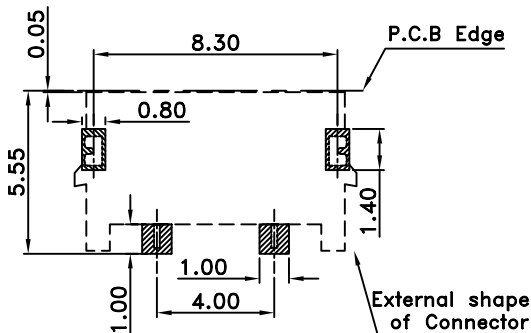
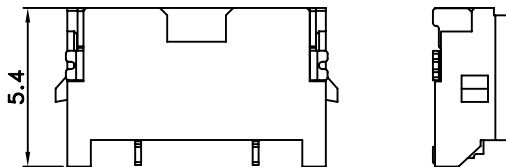
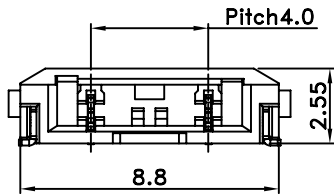

P.C.B LAYOUT

UL: Recognized NO. E306230